

NOTICE OF MINERAL TITLE APPLICATIONS OVER ABORIGINAL LAND

MINERAL TITLES ACT SECTION 71

Objections/Submissions to Mineral Title applications (s71 [3])

The landowner(s) of land in respect of which the following applications are made may lodge an objection to the grant of the application; any other persons may lodge a submission. Objections and submissions must be lodged in writing to the Department of Primary Industry and Resources, GPO Box 4550, DARWIN NT 0801 or emailed to titles.info@nt.gov.au. Objections and submissions can also be lodged at Centrepoint Building, 48-50 Smith Street, Darwin, within 30 days from the relevant Notification Date, which is set out below.

Exploration Licence 31392 sought by GBE EXPLORATION PTY LTD, ACN 121 535 948 over an area of 239 Blocks (746 Sq Kms) depicted below for a term of 6 years, within the SIDDELEY locality.

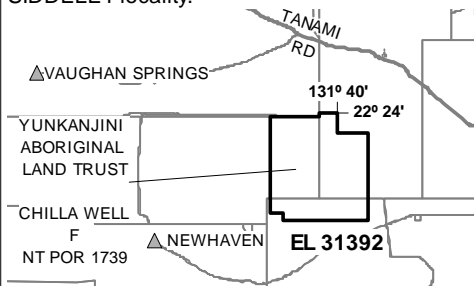

Not To Scale NMIG Map Sheet No: 5252

Exploration Licence 31393 sought by GBE EXPLORATION PTY LTD, ACN 121 535 948 over an area of 241 Blocks (763 Sq Kms) depicted below for a term of 6 years, within the SIDDELEY locality.

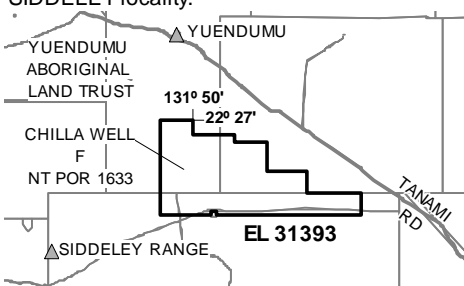

Not To Scale NMIG Map Sheet No: 5252

Exploration Licence 31355 sought by GIANTS REEF EXPLORATION PTY LTD, ACN 009 200 346 over an area of 28 Blocks (78 Sq Kms) depicted below for a term of 6 years, within the TENNANT CREEK locality.

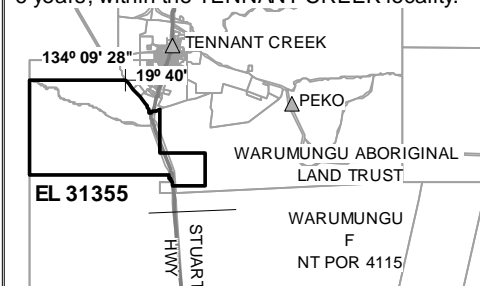

Not To Scale NMIG Map Sheet No: 5758

Notification Date: 23 November 2016